

SPEED HANDLE CONTROL PACKAGE
906-02001 LARGE HORIZONTAL

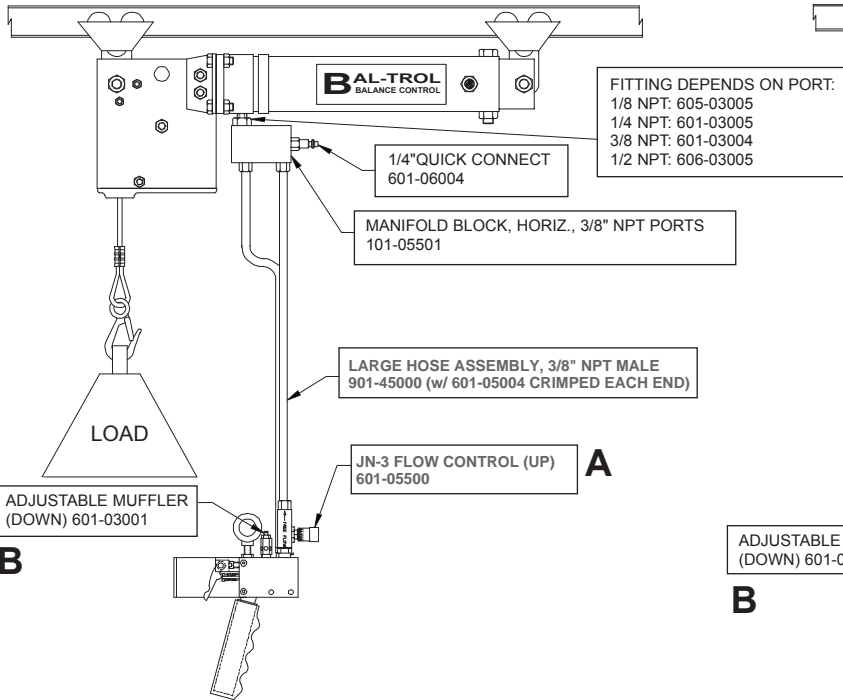

SPEED HANDLE CONTROL PACKAGE
906-02000 LARGE VERTICAL

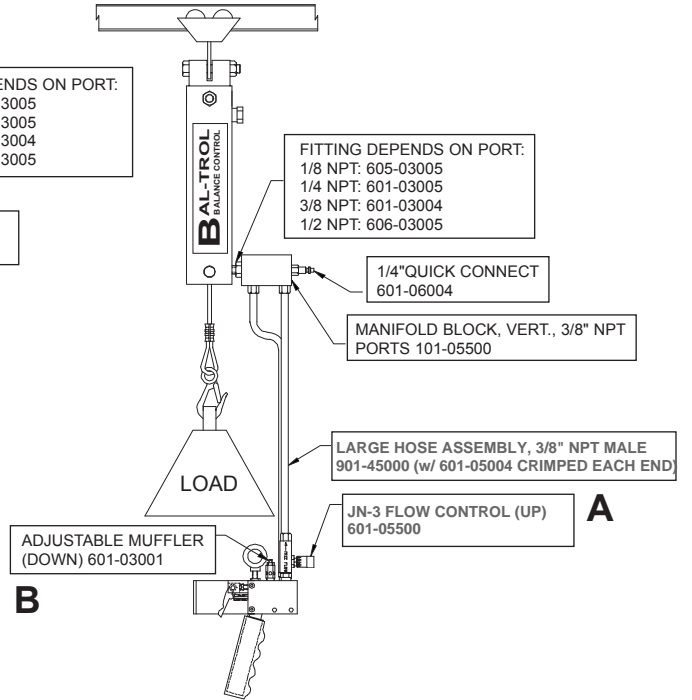

SPEED HANDLE CONTROL NO. 901-07000

HOOK-UP

1. Attach load to safety hook. Make sure load is secured.
2. Make sure all air lines are secure.
3. Connect filtered, lubricated and regulated air supply to air inlet, (80-100 PSI).

SPEED ADJUSTMENT

1. Turn speed control (A) clockwise until air is shut off.
2. Slowly turn speed control counter-clockwise while operating speed handle until desired up speed is obtained.
3. Adjust muffler (B) while operating speed handle until desired down speed is obtained.

PARTS LIST

* SEAL KIT PARTS

DESCRIPTION	PART NO.	QTY.
1. LEVER (UP)	101-07002	1
2. LEVER (DOWN)	101-07003	1
3. SPRING RETAINER	101-06005	2
4. LEVER PIN	301-01704	1
5. LEVER SPACER	101-07006	1
6. 1/4-20 X 3/4 SHCS	303-01311	2
7. LEVER HOUSING	101-07008	1
9. EYEBOLT	803-02706	1
10A. ADJUST. MUFFLER	601-03001	1
10B. JN-3 FLOW CNTRL	601-05500	1
10C. MALE ADAPTER	601-03004	1
11. REDUCER FITTING	601-03006	2
12. BODY	101-07001	1
13. PIPE PLUG	602-04000	2
*14. O-RING	401-00412	4
15. METERING SPOOL	101-06002	2
16. METERING PIN	101-06003	2
17. HANDLE GUARD	101-07000	1
*18. RETAINING RING	301-01812	2
*19. SPRING	801-04211	2
20. PILOT WASHER	101-06004	2
21. 10-32 X 1/4 BHCS	301-01316	6
*22. O-RING	401-04000	2

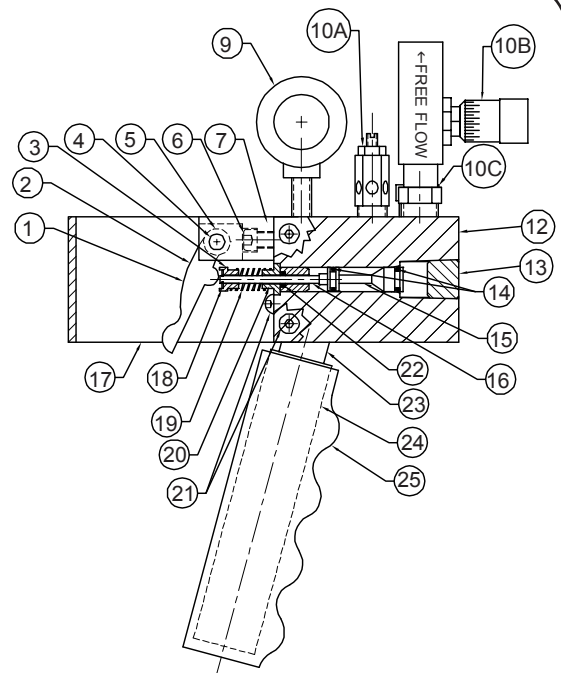

DESCRIPTION	PART NO.	QTY.
23. SET SCREW 1/2-20 X 1"	101-07005	1
24. HANDLE	101-07004	1
25. HANDLE COVER	105-07004	1