

SPEED HANDLE CONTROL NO. 901-07000

HOOK-UP

1. Attach load to safety hook. Make sure load is secured.
2. Make sure all air lines are secure.
3. Connect filtered, lubricated and regulated air supply to air inlet, (80-100 PSI).

SPEED ADJUSTMENT

1. Turn speed control (A) clockwise until air is shut off.
2. Slowly turn speed control counter-clockwise while operating speed handle until desired up speed is obtained.
3. Adjust muffer (B) while operating speed handle until desired down speed is obtained.

PARTS LIST

* SEAL KIT PARTS

| DESCRIPTION | PART NO. | QTY. |
|---------------------------|-----------|------|
| 1. LEVER (UP) | 101-07002 | 1 |
| 2. LEVER (DOWN) | 101-07003 | 1 |
| 3. SPRING RETAINER | 101-06005 | 2 |
| 4. LEVER PIN | 301-01704 | 1 |
| 5. LEVER SPACER | 101-07006 | 1 |
| 6. 1/4-20 X 3/4 SHCS | 303-01311 | 2 |
| 7. LEVER HOUSING | 101-07008 | 1 |
| 9. EYEBOLT | 803-02706 | 1 |
| 10A. ADJUST. MUFFLER | 601-03001 | 1 |
| 10B. JF-2 FLOW CNTRL | 601-05400 | 1 |
| 11. REDUCER FITTING | 601-03006 | 2 |
| 12. BODY | 101-07001 | 1 |
| 13. PIPE PLUG | 602-04000 | 2 |
| *14. O-RING | 401-00412 | 4 |
| 15. METERING SPOOL | 101-06002 | 2 |
| 16. METERING PIN | 101-06003 | 2 |
| 17. HANDLE GUARD | 101-07000 | 1 |
| *18. RETAINING RING | 301-01812 | 2 |
| *19. SPRING | 801-04211 | 2 |
| 20. PILOT WASHER | 101-06004 | 2 |
| 21. 10-32 X 1/4 BHCS | 301-01316 | 6 |
| *22. O-RING | 401-04000 | 2 |
| 23. SET SCREW 1/2-20 X 1" | 101-07005 | 1 |

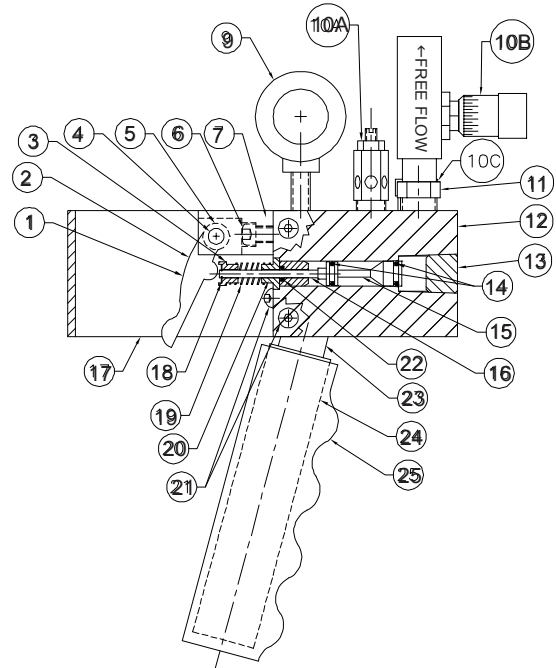

| DESCRIPTION | PART NO. | QTY. |
|------------------|-----------|------|
| 24. HANDLE | 101-07004 | 1 |
| 25. HANDLE COVER | 801-07001 | 1 |